



MSR Gold™ SA Double Ended

MSR Gold™ 700 SA/2 DE 1CT/4

To optimize the total lifetime of the double ended MSR Gold™ SA Double Ended lamps, the caps are plated with gold. This provides superior heat protection and thereby minimizes premature failure of the lamp and lamp holder, as well as ensuring extended consistent performance. In addition, the highly innovative P3 technology, developed by Philips, allows the lamp to be used at higher temperatures, which further extends service life and consistency of high-quality light output.

Product data

• General Information

Cap-Base	SFC10-4 [SFC10-4]
Operating Position	UNIVERSAL [Any or Universal (U)]
Main Application	Studio/Disco
Life To 50% Failures (Nom)	750 h
System Description	SA/2 DE

• Light Technical

Color Code	- [Not Specified]
Luminous Flux (Min)	47000 lm
Luminous Flux (Nom)	56000 lm
Chromaticity Coordinate X (Nom)	299
Chromaticity Coordinate Y (Nom)	320
Correlated Color Temperature (Nom)	7500 K
Luminous Efficacy (rated) (Nom)	80 lm/W
Color Rendering Index (Nom)	75

• Operating and Electrical

Power (Rated) (Nom)	700 W
---------------------	-------

Lamp Current (Nom)	11,5 A
Ignition Supply Voltage (Min)	198 V

• Controls and Dimming

Dimmable	No
----------	----

• Mechanical and Housing

Cap-Base Information	SFC10-4
----------------------	---------

• Luminaire Design Requirements

Pinch Temperature (Max)	500 °C
-------------------------	--------

• Product Data

Full product code	871829122123400
Order product name	MSR Gold™ 700 SA/2 DE 1CT/4
EAN/UPC - Product	8718291221234
Order code	928174705115
Numerator - Quantity Per Pack	1
Numerator - Packs per outer box	4
Material Nr. (12NC)	928174705115
Net Weight (Piece)	34.000 g

PHILIPS

MSR Gold™ SA Double Ended

Warnings and Safety

- A lamp breaking is extremely unlikely to have any impact on your health. If a lamp breaks, ventilate the room for 30 minutes and

remove the parts, preferably with gloves. Put them in a sealed plastic bag and take it to your local waste facilities for recycling. Do not use a vacuum cleaner.

Dimensional drawing

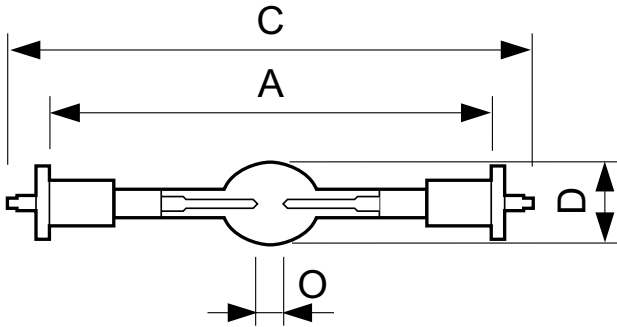

MSR Gold™ SA/DE

MSR GOLD 700 SA/2 DE

Product	D	O	A	A	A	C
MSR Gold™ 700 SA/2 DE 1CT/4	19 mm	4.0 mm	114.4 mm	115.2 mm	114.8 mm	136 mm

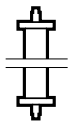

Photometric data

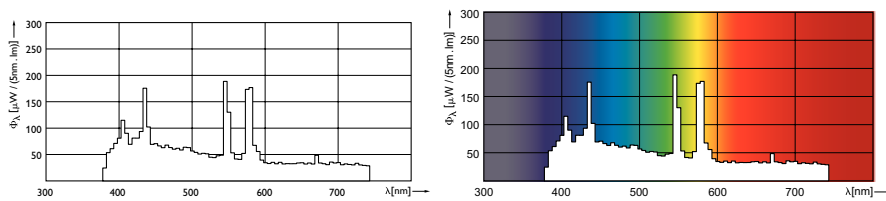

© 2016 Philips Lighting Holding B.V.
All rights reserved.

Specifications are subject to change without notice. Trademarks are the property of Koninklijke Philips N.V. (Royal Philips) or their respective owners.

www.philips.com/lighting

2016, November 1
data subject to change